

MANUAL SLIDING WALL SYSTEM – GEZE MSW  
TRANSPARENCY AND FUNCTIONALITY



**CONTENTS**

GEZE MSW	<b>4</b>
Product description	<b>4</b>
GEZE MSW with sliding glass elements (SBT)	<b>5</b>
Overview MSW with SBT	<b>6</b>
GEZE MSW with laminated safety glass (VSG)	<b>8</b>
Technical details	<b>9</b>
Versions	<b>10</b>
Special solution: GEZE MSW with movable frame panic door	<b>11</b>
GEZE MSW with GGS	<b>12</b>
GEZE MSW with IGG	<b>13</b>
GEZE MSW with construction solutions	<b>14</b>
References	<b>15</b>



Multimedia House, Kopenhagen-Fredriksberg, Denmark

**GEZE MSW****GEZE manual sliding wall systems - versatility, transparency, design and safety**

Flexible functionality, design and a versatile range of application possibilities make GEZE's manual sliding wall systems (MSW) an ideal solution for transparent room partitioning. They can be used in shopping malls, in hotels and restaurants, in waiting areas of all kinds as well as for sophisticated solutions in private homes. MSW open, partition and separate rooms, and can be adapted to suit these uses. Thanks to the special material used for the clamp supports, the door elements can now be realised with greater construction heights, thus doing justice to the requirements of modern architecture in terms of spacious design and transparency.

**PRODUCT DESCRIPTION**

- The door elements are clamped at the top and bottom over the whole element width in carrier and clamping profiles.
- No glass bore holes are required for the basic mounting of GEZE MSW. This makes large tolerance compensation possible. Costs for glass processing are reduced. Sources of faults are almost excluded.
- The covers for the carrier and clamping profiles can be clipped on after the installation work has been completed. This way, the surfaces are protected from damage and scratching during installation.
- The running rail has grooves. The respective sliding blocks can be used to attach connecting brackets, for suspended ceilings, for example, without damaging the running rail.
- There are different finishes and colours available for perfect harmony with the building structure. The cover plates are exchangeable and can be replaced by a different colour at any time.
- With a maximum leaf weight of 150 kg, high-quality precision ball bearings guarantee very good running properties and low-noise operation.
- The variable arrangement of the stacking areas (parallel, at 90° to the running rail axis or special stacking areas) creates optimum solutions for a wide variety of room situations.
- Since the geometry of the running rail profile can be straight, curved or polygonal, architects and planners have all the design freedom they want.



**GEZE MSW WITH SBT****GEZE MSW with sliding glass elements (SBT) - flexible user convenience**

Flexibility through functionality are the properties that make GEZE MSW as a whole and the sliding glass element in particular into an outstanding system. Salesroom design and goods presentation are key success factors for shop businesses. The large glass elements of the GEZE MSW system offer a clear view and can also be used as a swing door with closing function.

If the glass leaves are to remain closed, a salesroom or a café can be entered through the sliding glass element, which is transformed into a swing door in a matter of seconds. For this purpose, the door leaf is quickly moved into its hold-open position comfortably, without much force being used, because the locking and hold-open mechanisms are combined in one locking and hold-open element. The operating lever required is integrated in the profile of the sliding glass element. Returning the element to its sliding function is just as straightforward. Lock bolts prevent unwanted operation and guarantee additional safety.

**VARIANTS**

- Sliding double action door with floor spring GEZE TS 520
- Sliding single action door with manual door closer GEZE TS 3000 V
- Standard sliding swing door

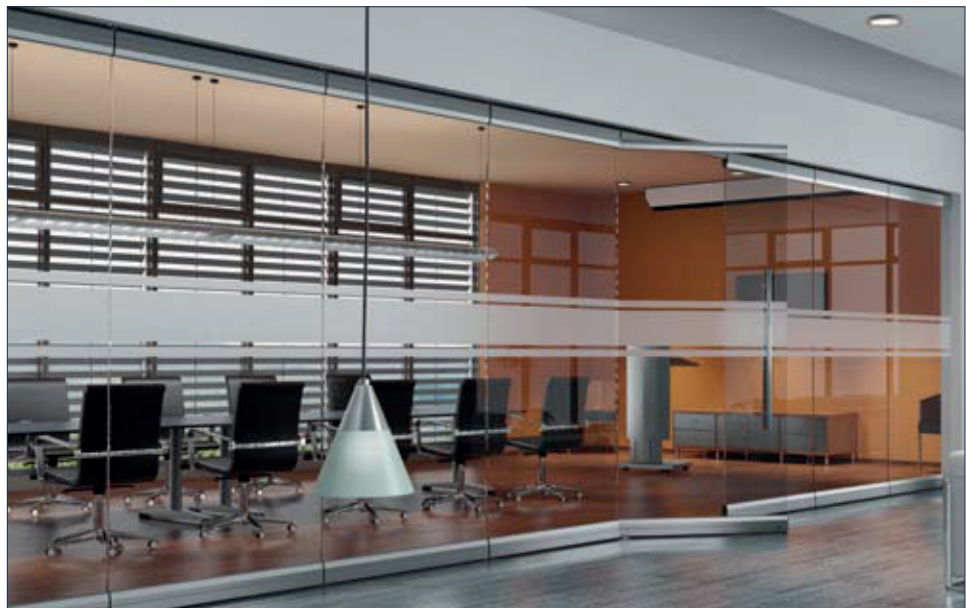

MSW with sliding glass elements

## OVERVIEW MSW WITH SBT

### Individual sliding walls for transparency and design

The sliding wall systems from GEZE are particularly suitable for modern, design-oriented all-glass solutions set in design freedom, not just in hotels and congress halls, shopping centres or at airports.



① Pivot bearing for SBT



② Locking for SBT

- Can be used for left-hand and right-hand doors
- Operating bolt for holding open and locking
- Connecting link mechanism controls movements and prevents incorrect operation
- Especially smooth-running thanks to high-quality bearings



③ Floor lock



demanding architecture. A flexible building block system and the integration of leaf elements with varying functions offers a wide range of

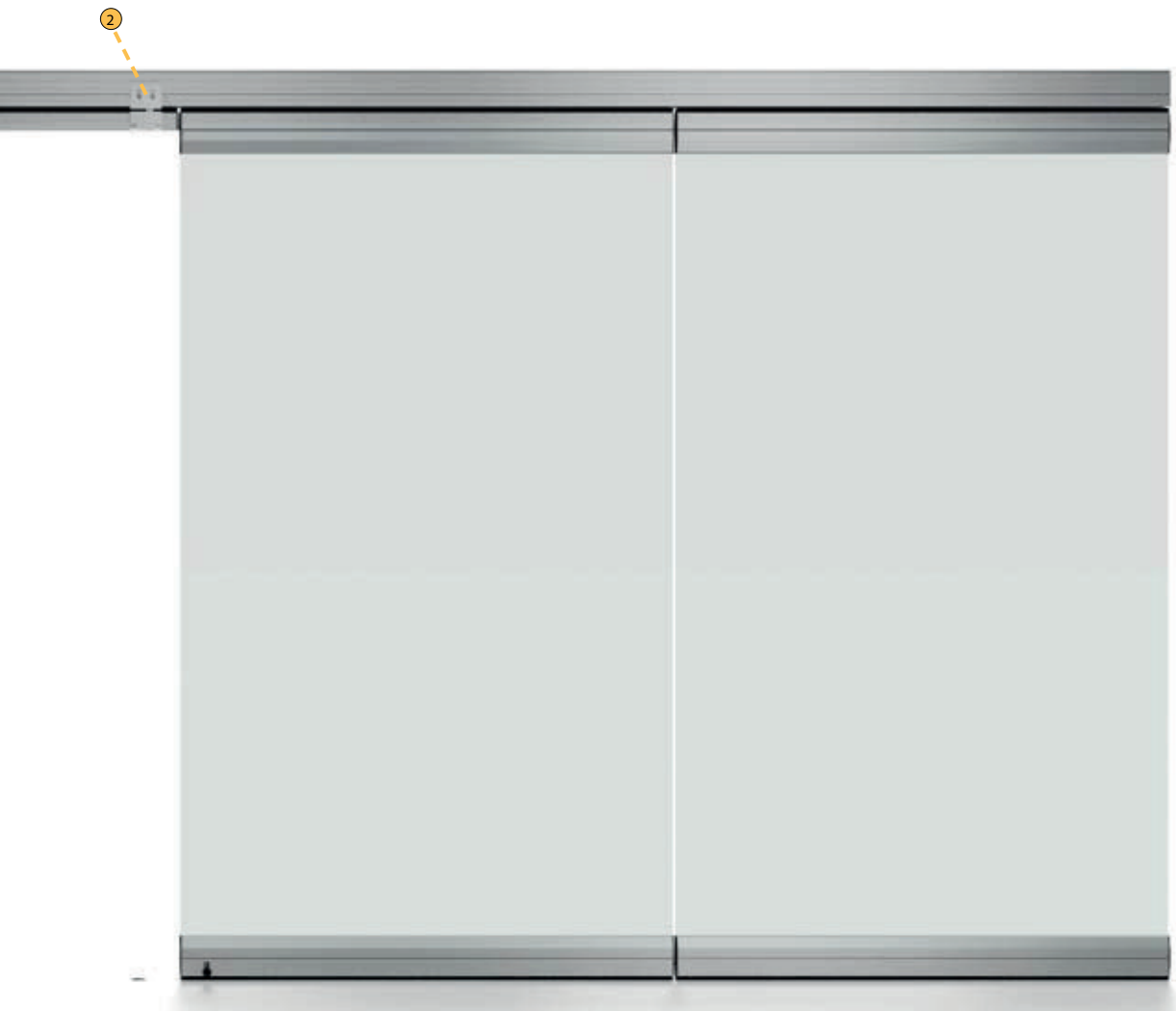

#### 4 Swiveling axle SDT/SAT

- Secured against unwanted operation by lock bolt
- Plastic plain bearing
- Straightforward door setting thanks to adjustment screw on the face side



#### 5 Operating lever for coupling mechanism

- Mounted captive on the element
- No additional tools necessary
- Secured against unwanted operation by lock bolt
- Folding handle



#### 6 Coupling mechanism

- Degressive cams combine high levering forces and good self-locking
- The rotary movement of the cam causes form-locking extension and retraction of the square
- The favourable height-width ratio of the sliding block prevents any jamming in the basic structure
- Adjustment in the longitudinal direction makes it easy to align the door



**GEZE MSW WITH VSG****GEZE MSW with laminated safety glass (VSG)**

MSW with VSG sliding panels made of heat-strengthened glass (TVG) or toughened safety glass (VSG) provide increased protection against burglary and minimise the risk of injury. The use of VSG made of heat-strengthened panes (TVG) allows operation to be continued temporarily even if the glazing is damaged, since the fragments mutually reinforce each other. The special VSG glue protection prevents the heavy VSG panes from slipping out of the carrier and clamp profile. Additional glass or profile processing is not necessary.

**PRODUCT FEATURES**

- No glass processing necessary
- Process-safe gluing using the system gluing set with all the necessary accessories (glue, activator, cleaner, staple)
- Profile processing unchanged
- Independent of width, one set for all element widths
- Patented

**VSG GLUING OF THE MSW**

Carrier and clamp profile with VSG glue protection

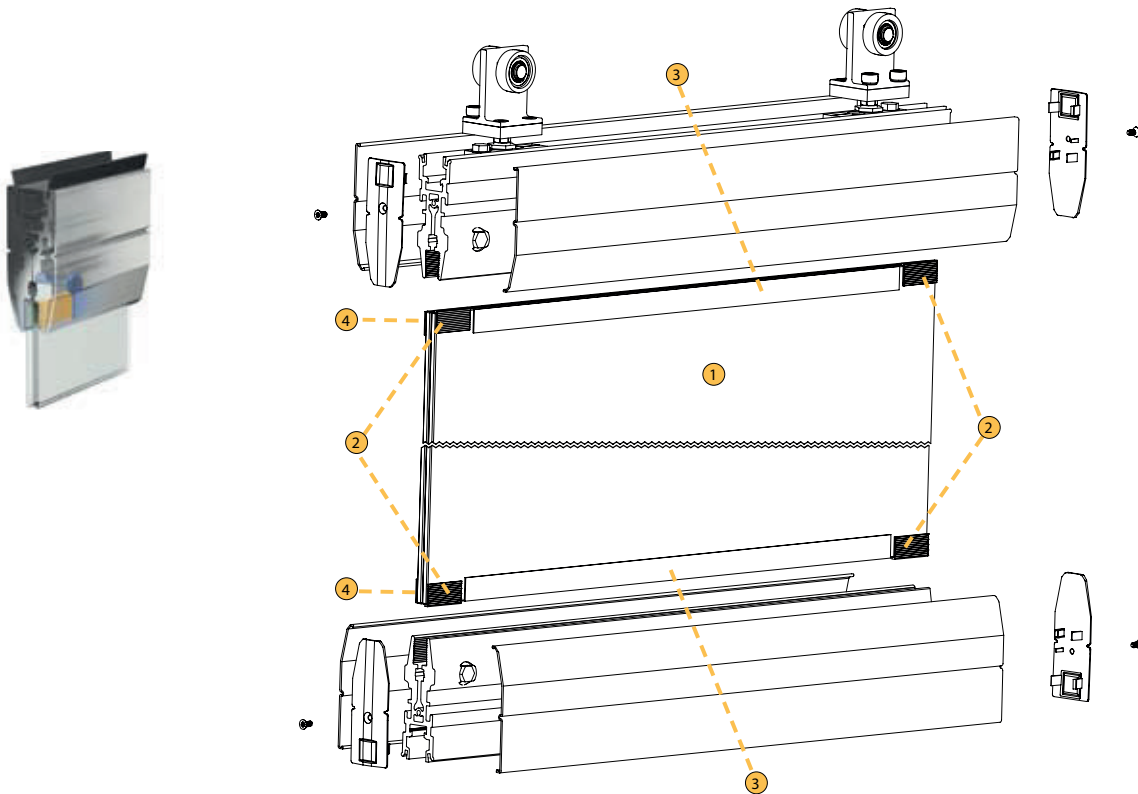

- ① Laminated safety glass
- ② Grooved corner, stuck on one side
- ③ Clamp insert, 1 mm on grooved corner side
- ④ Clamp insert (side opposite grooved corner), design depending on glass thickness



## TECHNICAL DETAILS

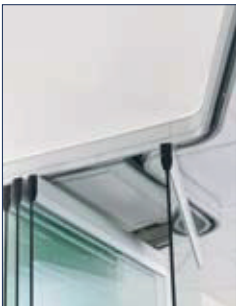

Technical features manual sliding door MSW:

- Max. passage height 4000 mm
- Max. door width 1500 mm (depending on door version)
- Max. door weight (depending on door version)
  - up to 100 kg with single carriage
  - up to 150 kg with double carriage

Technical features of sliding glass elements SBT:

- Max. passage height 3500 mm
- Max. door width 1100 mm
- Max. door weight 120 kg

The stacking area for the door elements can be designed parallel, 90° to the running rail axis or special stacking area. All the stacking areas can be executed with or without stacking area panelling, which means both double rails or single rails can be used depending on the installation situation.

In their standard version, the surfaces of the running rail profiles are made of anodised aluminium

in the colour EV1. When a double rail is used, powder coatings according to RAL are possible. The geometry of the running rails can be straight, curved or polygonal.

The glass doors of the manual sliding wall system GEZE MSW are held at the top and bottom over the whole element width by carrier and clamp profiles. There are clip-on covers available for carrier and clamp profiles in two different versions:

- following the contour of the carrier and clamp profile
- as a rectangular profile

The horizontal sealing of the door elements is through sealing brushes mounted at the top and bottom. A complete floor guide for the manual sliding wall GEZE MSW is available on request.

<b>Locking/locks</b>	Floor-level locking on the face side (standard) or front Single-bolt security lock (as floor lock) for profile cylinders and square bolt
<b>Versions</b>	<b>GEZE MSW (line-design):</b> All-glass with continuous carrier and clamp profiles - (top and bottom), toughened safety glass (ESG) 10 mm or 12 mm thick, alternatively VSG 10 mm or VSG 12 mm <b>GEZE MSW with all-glass fittings (GGS) (spot-type):</b> All-glass with spot-type carrier and guide fittings made of stainless steel, toughened safety glass (ESG) 10 mm or 12 mm thick, alternatively VSG 10 mm or VSG 12 mm <b>GEZE MSW integrated all-glass (IGG):</b> invisible frameless insulated glass leaf with all-round edge printing. Standard version with panes 2 x 6 mm ESG and pane gap (SZR) = 27 mm or VSG 10 mm <b>GEZE MSW construction:</b> Support profiles in combination with "per- manent" leaves (wood, aluminium, plastic)
<b>Door versions</b>	The door elements of the GEZE MSW can be executed as follows: Horizontal fixed doors as a double-action door with floor-mounted door closer GEZE TS 550 NV as a swing door with floor bearing as a single-action door with outer pivot bearing as a fixed panel Horizontally moving doors as sliding door Sliding glass element SBT (not for IGG, GGS, permanent leaves)

## VERSIONS

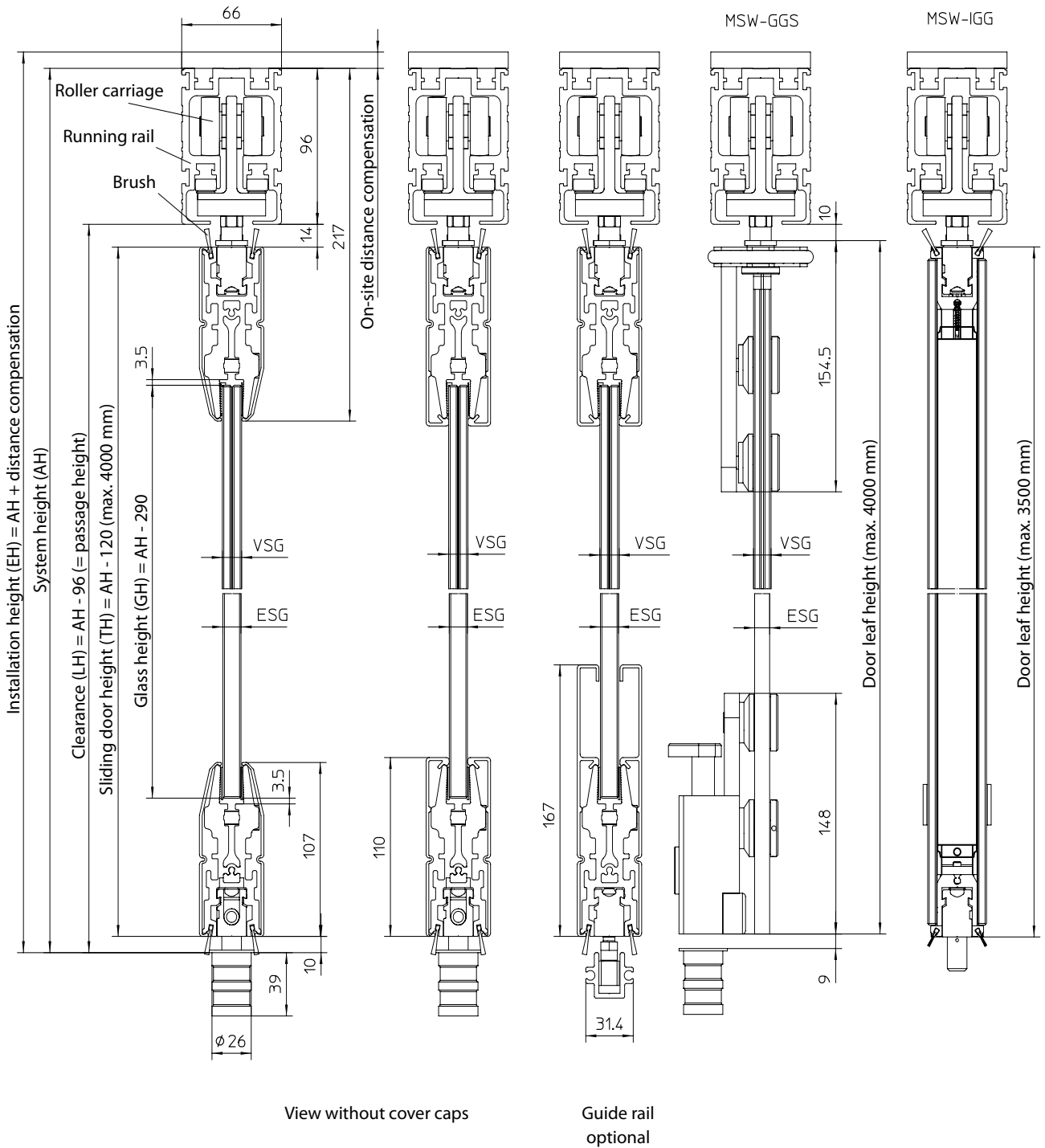

A version with permanent leaves is also possible.

SPECIAL SOLUTION - PROJECTED SOLUTION

GEZE MSW – Manual sliding wall system with movable frame panic door

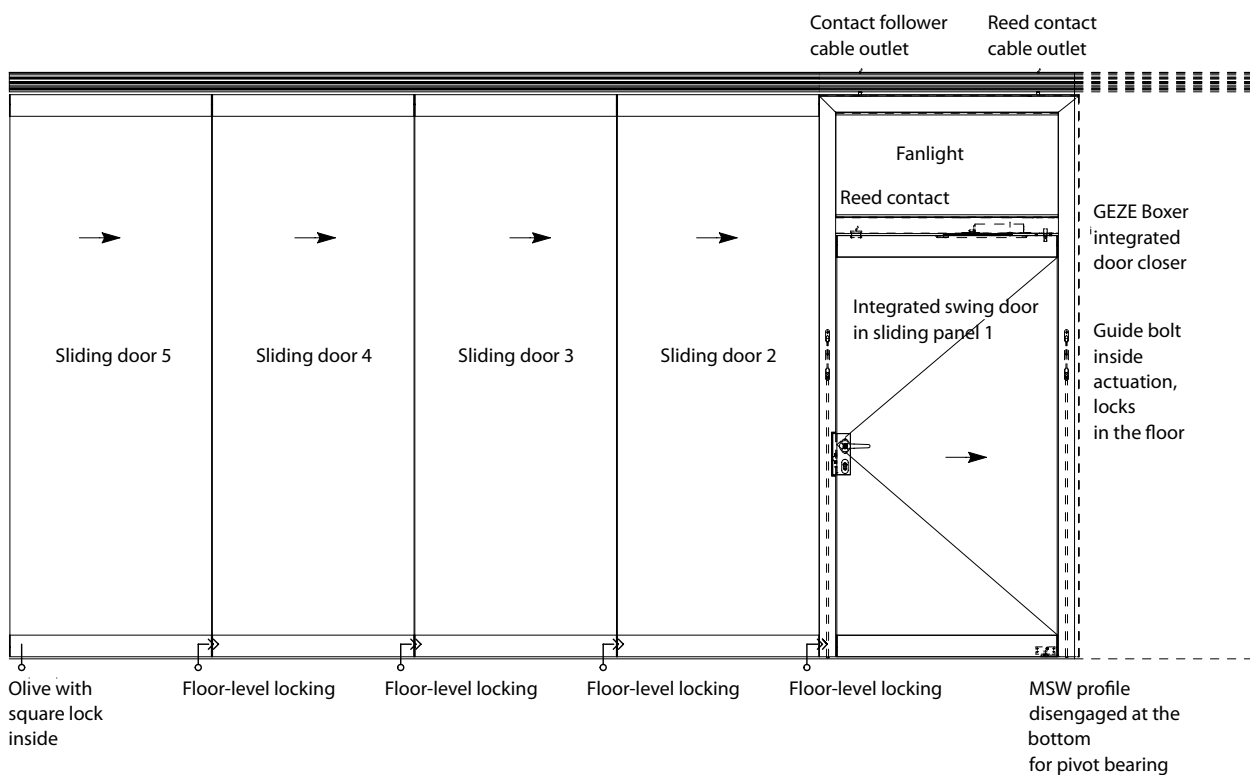

Deutsche Bank, Leonberg, Germany



GEZE MSW with GGS

**GEZE MSW WITH GGS****GEZE MSW with all-glass design fittings – room partitioning with all-glass elements**

An MSW with spot-fixed all-glass design fittings (GGS) offers maximum transparency. Fittings are not reduced at the cost of functionality and operating comfort, however: the floor-level locking feature can be actuated conveniently by foot, without having to bend down – an advantage particularly valued by female sales staff in elegant shopping malls. The characteristic feature is the spot-fixing of the glass elements combined with the tried-and-trusted GEZE MSW rail profile. The flexible height adjustment is guaranteed here, too, with long holes in the roller carriage fittings. Depending on the weight of the door leaf, versions are possible with a single or double roller carriage fin. The glass elements can be made as ESG or VSG versions depending on their usage.

**PRODUCT FEATURES**

- Operator-friendly fittings solution made of solid stainless steel
- Spot-type brackets flush to the glass offer optimum support
- Surface in grit 600 (furniture quality)
- Patented



Pavillon Lapidarij Novigrad, Istria, Croatia

### GEZE MSW WITH IGG

#### GEZE MSW with integrated all-glass system – partitioning systems with a view

The MSW system is a perfect design for an integrated all-glass system (IGG). MSW with IGG integrates the profiles and the fittings invisibly between the panes of glass – without bulky or visible elements at the surface of the glass. Any printing on the glass edge is on the inside of the pane, allowing the fitting technology to be concealed behind it. Manual sliding walls with IGG allow integrated aesthetics and a great deal of freedom in both planning and design. Whether individual designs are to be realised with screen printing motifs or special types of glass, for example, or blinds are to be intelligently integrated between the panes for the purpose of discretion – MSW with GEZE IGG offers a varied range of solutions for sophisticated architecture.

### PRODUCT FEATURES

- Aesthetic appearance thanks to frameless panes and continuous surfaces
- The profiles and fittings system are integrated invisibly between the panes of glass.
- Suitable for door leaf heights of up to 3500 mm and widths of up to 1200 mm
- Maximum leaf weight of up to 150 kg (with dual carriage)





Passarelle, Sony Center, Berlin, Germany

## GEZE MSW WITH CONSTRUCTION SOLUTIONS

### The uncomplicated link using manual sliding walls

Flexible and transparent room partitioning with manual sliding walls and constructions solutions

## PRODUCT FEATURES

- As an alternative to glass leaves, leaves made of wood, aluminium or plastic can be used with MSW from GEZE.
- For all variants:
  - Leaf weights of up to max. 150 kg
  - Leaf widths from 500 - 1500 mm
  - The support profiles are set in at the upper and lower edge of the permanent leaves

REFERENCES



Pavillon Lapidarij Novigrad, Istria, Croatia



Pavillon Lapidarij Novigrad, Istria, Croatia



Hotel Mövenpick, Stuttgart Airport, Germany



Hotel Mövenpick, Stuttgart Airport, Germany



Porsche AG Stuttgart, Germany



Augustinum, Stuttgart, Germany

**Máte-li zájem o některé z produktů, kontaktujte nás:**

**Pavel Brázda**

+420 775 711 124

brazda@termetal.cz

**Marek Bláha**

+420 775 711 125

blaha@termetal.cz

**termetalliving.cz**

**termetal**  
**living** 